

- A** Top Rail  
2" x 3-1/2" x 95-1/2"
- B** Mid Rail  
2" x 3-1/2" x 95-1/2"
- C** Pickets  
14 Pcs. of 7/8" x 3" x 69-7/8"  
8 Pcs. of 3/4" x 1-1/2" x 69-7/8"
- D** Bottom Rail  
2" x 3-1/2" x 95-1/2" (Includes  
Reinforcement Channel.)
- E** Post  
5" x 5" x 108"

## SPS Madeline 8'x6' Section

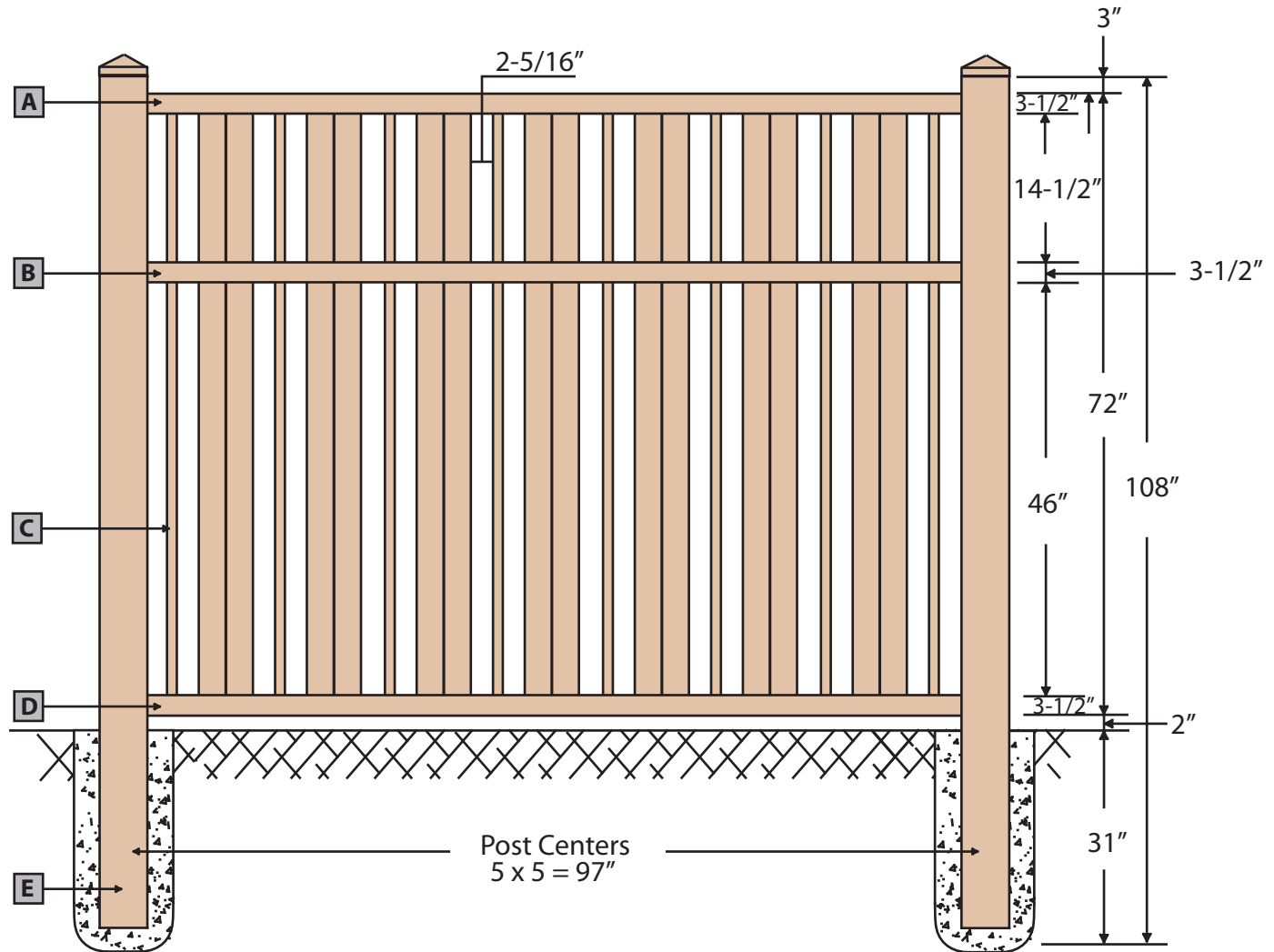

Generations

by Stephens Pipe

### SPS Madeline 8'x6' Section

Approved By	Revision NO.
Approved Date	Effective Date

Drawing NO.  
**PVC-MAD-ST8x6**